

THESE DRAWINGS ARE THE PROPERTY OF QUALTEK ELECTRONICS AND NOT TO BE REPRODUCED FOR OR COMMUNICATED TO A THIRD PARTY WITHOUT THE EXPRESS WRITTEN PERMISSION OF AN OFFICER OF QUALTEK ELECTRONICS.

REVISION			
REV.	DESCRIPTION	DATE	APPROVED
B	RoHS Compliancy	06-01-06	DP
C	Depth Change to meet UL 60320 and Updated Approvals	11-08-19	LY

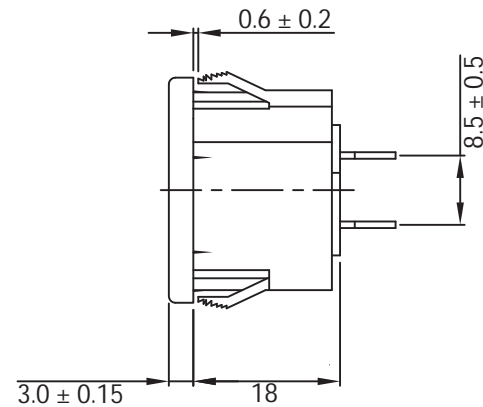
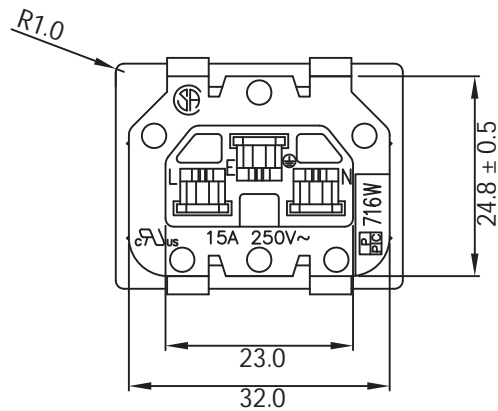
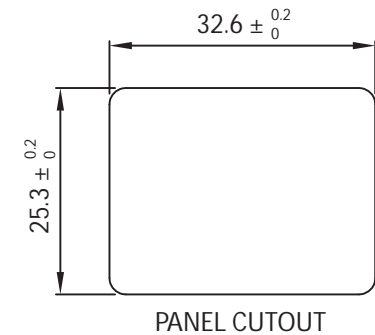
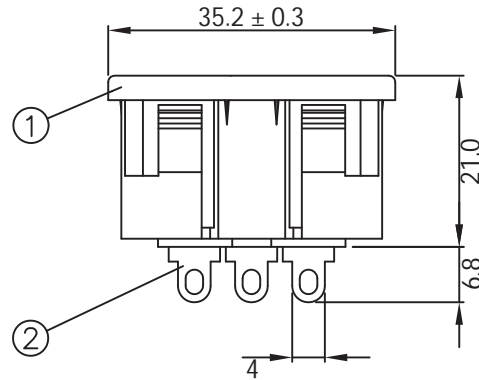
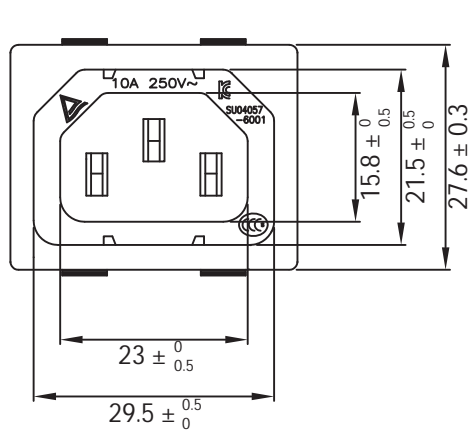

NOTES:

RATING:

UL, CSA: 15A 250V AC  
 TUV, CCC: 10A 250V AC  
 APPROVALS: UL, CSA, TUV, CCC  
 PANEL THICKNESS: 0.8~2.0mm  
 RoHS COMPLIANT

**CONTROLLED**

2	Contact PIN Brass Strip t=0.8mm Tin-Plated	3	
1	Body Insulator PC Black Color UL94V-2	1	
Dim range (mm)	Tolerance +/- (mm)	<b>Qualtek Electronics Corp.</b>	
		PPC DIVISION	
		Part Number: <b>716W-X2/01</b>	<b>RoHS Compliant</b>
		Description: <b>AC RECEPTACLE</b>	
0-1	0.40	UNIT: mm	REV. C
1-6	0.40		
6-18	0.50	Drawn / Date	Checked / Date
18-50	0.50		
50-120	0.70	B.ZHANG 05-20-04	Approved / Date
120-250	0.90		
250-500	1.20		
		05-20-04	JH / 05-20-04