

⑤ **USB 2.0 COMPLIANT**

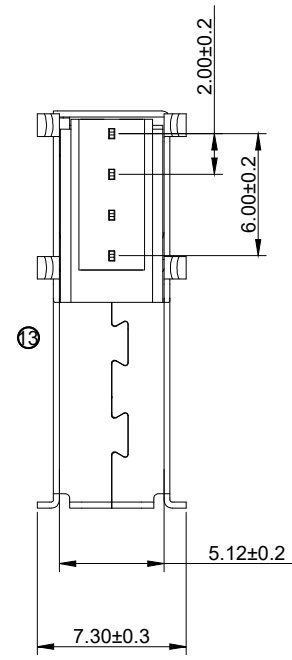

**NOTES:**

- ⑫ 1. Material:
  - 1.1 Housing: PBT+30%GF UL94V-0, LCP+30%GF UL94V-0,
  - 1.2 Cover: PBT +30%GF UL94V-0, LCP+30%GF UL94V-0,
  - ⑬ 1.3 Shell: Copper Alloy C2680
  - ⑬ 1.4 Contact :Copper Alloy C2680
- 2. FINISH:
  - 2.1 Contact Area: 1u"Au-flash/Selective 30u"Au/Selective
  - Solder Area: Tin Plated
  - Under: Ni Plated
- 3. MECHANICAL:
  - 3.1 Mating Force: 3.57kgf Max.
  - 3.2 Unmating Force: 1.02kgf Min
  - 3.3 Durability: 1500 cycles Min
- 4. ELECTRICAL:
  - 4.1 Current Rating: 1.5A
  - 4.2 Dielectric Strength: 500V AC FOR 1 MINUTE
  - ⑥ 4.3 Contact Resistance: 30mΩ Max
  - 4.4 Insulation Resistance: 1000 MΩ Min
  - ⑩ 4.5 Voltage Rating: 30VAC
  - 5. Operating temperature: -55°C TO +85°C
  - ⑩ 6. For wave soldering temperature : 235°C, 5sec max
  - ⑫ For reflow soldering temperature: 260°C, 5sec max
  - ⑫ 7. PACKING: Tray

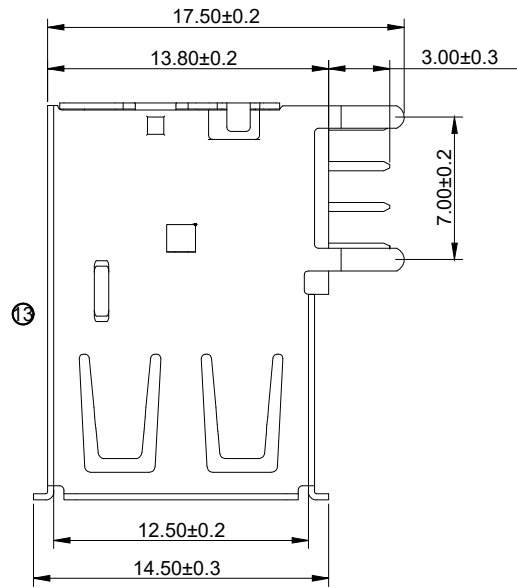
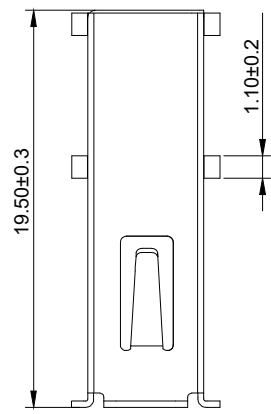
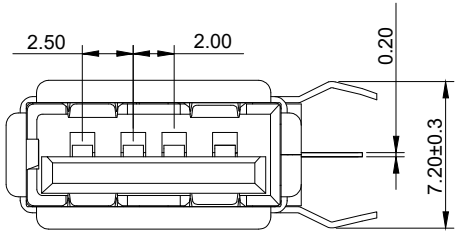
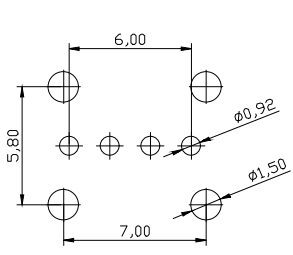

RECOMMENDED PCB LAYOUT(TOP VIEW)  
GENERAL TOLERANCES: ±0.05

⑫⑬	WSW-P/N	Plating	Housing /Cover	Soldering Style
	A-USB A-E	Gold Flash Selective Tin	PBT+30%GF(White)	THT(Wave soldering)
	A-USB A-E-BK		PBT+30%GF(Black)	THT(Wave soldering)
	A-USB A-E-THR		LCP+30%GF(White)	THR(Reflow soldering)
	A-USB A-E-THR-BK	30u"Gold Selective Tin	LCP+30%GF(Black)	THR(Reflow soldering)
	A-USB/2-A-E		PBT+30%GF(White)	THT(Wave soldering)
	A-USB/2-A-E-BK		PBT+30%GF(Black)	THT(Wave soldering)
	A-USB/2-A-E-THR		LCP+30%GF(White)	THR(Reflow soldering)
	A-USB/2-A-E-THR-BK		LCP+30%GF(Black)	THR(Reflow soldering)

G	RoHS compliant Unit:mm	Scale	Free	⑬	Update	26.05.2021	Luca	Date	Name	Description: USB 2.0 Connector Female / A-type / 4Pin / Side 90°		
		TOLERANCE		⑫	Update	26.11.2020	Luca				Drawn	26.01.2005
		X.X	±0.3	①	Update PN	17.11.2020	Luca	Approved	26.05.2021	Luca	ASSMANN WSW-No. A-USB A-E-x-x A-USB/2-A-E-x-x⑫	
		X.XX	±0.2	⑩	Update	31.10.2019	Carson					
		X.XXX	±0.1	⑨	Update dimension	14.03.2019	Winnie				Drawing-No.	ASS 1413B CO rev13
		DIM	TOL	8	Update Pin-number on recom. PCB	05.09.2017	S.Bölling				Customer-No.	
H		ANG.	±5°									
		Angle	TOL	Id.	Modification	Date	Name					