



ANATECH ELECTRONICS INC
RF & Microwave Filters & Products

4100-4500 MHz / 4600-5000 MHz Cavity Duplexer

Part Number: AD4300-4800D369



<u>Characteristics</u>	<u>Band 1</u>	<u>Band 2</u>
Passband:	4100-4500 MHz	4600-5000 MHz
Bandwidth:	400 MHz	400 MHz
Passband Return Loss:	12 dB	12 dB
Passband Insertion Loss:	2 dB	2 dB
Passband Ripple:	0.2 dB	0.2 dB
Input / Output Impedance:	50 Ohms	50 Ohms
Isolation:	40 dB	40 dB
Power Handling:	1 Watt	1 Watt

<u>Mechanical</u>	
Mounting Method:	Threaded Mounting Holes
Connector Type:	SMA (F)
Dimensions:	2.08 x 1.08 x 0.84 Inches

<u>Environmental</u>	
Operating Temperature:	-40 to +70 deg.C
Storage Temperature:	-50 to +90 deg.C

Outline Drawing:

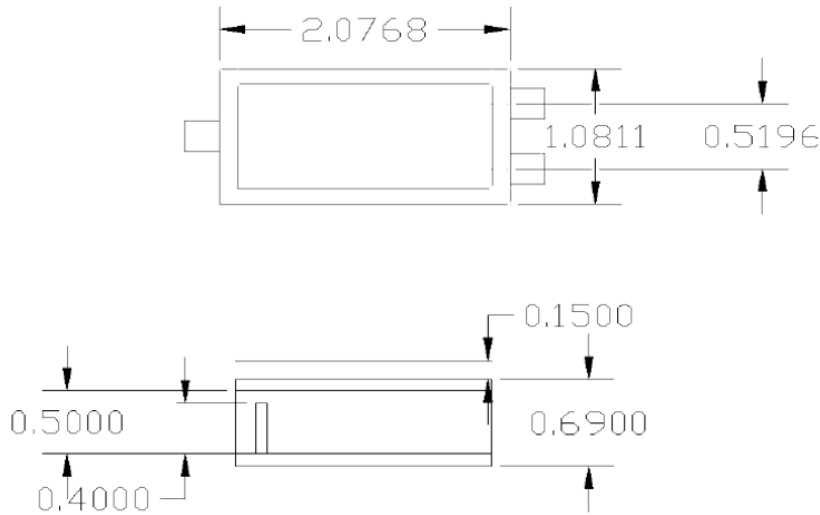



ANATECH ELECTRONICS INC
RF & Microwave Filters & Products

**4100-4500 MHz / 4600-5000 MHz
Cavity Duplexer**

Part Number: AD4300-4800D369



Response Plot:

