

SPRING-LOADED CONNECTORS







precip-dip

WWW.PRECIDIP.COM TEL +41 32 421 04 00 SALES@PRECIDIP.COM

QUICK SELECTOR CHART

SPRING-LOADED CONNECTORS AND PAD CONNECTORS

GRID

| 1.25 mm | 2 mm | 2.54 mm |
|------------|------------|------------|
| SINGLE ROW | SINGLE ROW | SINGLE ROW |
| | DOUBLE ROW | DOUBLE ROW |

SLC CONNECTORS

SEE PAGE

| | | | | | |
|---|--|----|----|----|--------|
| Straight solder tail | | 32 | | 34 | 34 |
| Right angle solder tail | | 32 | | | |
| Surface mount perpendicular | | | 33 | 33 | 35, 36 |
| Surface mount perpendicular with positioning pins | | | | | 37 |
| Surface mount parallel | | | | | 38 |
| SIM card socket | | | | | 38 |

PAD CONNECTORS

| | | | | | |
|-----------------------------|--|--|--|----|----|
| Surface mount perpendicular | | | | 39 | 39 |
| Surface mount parallel | | | | 39 | |

The values listed below are general specs applying for PRECI-DIP spring-loaded connectors. Please see individual catalog page for additional and product specific technical data.

| | |
|------------------------------------|--|
| OPERATING TEMPERATURE RANGE | -55 ... +125 °C (-55 °... +85 °C with music wire spring) |
| CLIMATIC CATEGORY (IEC) | 55/85/21 |
| OPERATING HUMIDITY RANGE | Annual mean 75% |
| MAX. WORKING VOLTAGE | 100 V _{RMS} /150 V _{DC} (2.54 mm grid) |



PRECI-DIP products are recognized by Underwriters Laboratories Inc. and listed under "Connectors for Use in Data, Signal, Control and Power Applications", File Nr. E174442.

MECHANICAL CHARACTERISTICS

| | BASIC HOLLOW PISTON TYPE | LOW RESISTANCE SHAPED PISTON TYPE | LOW RESISTANCE CLIP IN-LINE DESIGN TYPE |
|----------------------------------|-----------------------------|--------------------------------------|--|
| MIN. INITIAL HEIGHT | 3 mm | 6 mm | 10 mm |
| STROKE/HEIGHT RATIO | Max. 0.3 | Max. 0.2 | Max. 0.15 |
| MAX STROKE | 2 mm | 2 mm | 1.5 mm |
| MIN. INITIAL SPRING FORCE | 0.2 N | 0.2 N | 0.2 N |

ELECTRICAL CHARACTERISTICS

| | |
|--|---------------------------------------|
| INSULATION RESISTANCE BETWEEN ANY TWO ADJACENT CONTACTS | Min. 10'000 MΩ at 500 V _{AC} |
| CAPACITANCE BETWEEN ANY TWO ADJACENT CONTACTS | Max. 1 pF |

ENVIRONMENTAL CHARACTERISTICS

The sockets withstand the following environmental tests without mechanical and electrical defects:

- Dry heat steady state IEC 60512-11-9.11i / 60068-2-2.Bb: 125 °C, 16 h
 - Damp heat cyclic IEC 60512-11-12.11m / 60068-2-30.Db: 25/55 °C, 90 – 100 %rH, 1 cycle of 24 h
 - Cold steady state IEC 60512-11-10.11j / 60068-2-1.A: -55 °C, 2 h
 - Thermal shock IEC 60512-11-4.11d / 60068-2-14.Na: -55/125 °C, 5 cycles 30 min
 - Sinusoidal vibrations IEC 60512-6-4.6d / 60068-2-6.Fc: 10 to 500 Hz, 10 g, 1 octave/min, 10 cycles for each axis
 - Shock IEC 60512-6-3.6c / 60068-2-27.Ea: 50 g, 11 ms, 3 shocks in three axis
- During the above two tests, no contact interruption >50 ns does appear.

- Solderability J-STD-002A, Test A, 245 °C, 5 s, solder alloy SnAg3.8Cu0.7
- Resistance to soldering heat J-STD-020C, 260 °C, 20 s
- Moisture sensitivity J-STD-020C level 1
- Resistance to corrosion:
 - 1) Salt spray test IEC 60068-2-11.Ka: 48 h
 - 2) Sulfur dioxide (SO₂) test IEC 60068-2-42 Kc: 96 h at 25 ppm SO₂, 25 °C, 75 %rH
 - 3) Hydrogen sulfide (H₂S) test IEC 60068-2-43 Kd: 96 h at 12 ppm H₂S, 25 °C, 75 %rH

PACKAGING

- Standard connector packaging is card box.
- SMD mount connectors available on request with Tape & Reel packaging acc. to EIA Standard 481. These products are marked with the symbol:

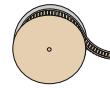

T & R Packaging

Please consult www.precidip.com for availability, size of tape, size of reel, number of components per reel and packing units.



preci-dip

WWW.PRECIDIP.COM TEL +41 32 421 04 00 SALES@PRECIDIP.COM

SPRING-LOADED CONNECTORS

1.25 mm GRID / SINGLE ROW / SOLDER TAIL

Fine pitch connectors with spring-loaded contacts (SLC), solder tail. High-rel contacts with clip, patented in-line design.

TECHNICAL SPECIFICATIONS (FOR GENERAL SPECS, SEE PAGE 31)

| | | |
|---------------------------|--|----------------------|
| INSULATOR | Black glass filled polyester PCT-GF30-FR | |
| FLAMMABILITY | UL 94V-0 | |
| PISTON AND BARREL | Brass CuZn36Pb3 (C36000) | |
| CONTACT CLIP | Beryllium copper (C17200) | |
| SPRING | Stainless steel X12 CrNi177, DIN 17224 | |
| MAX. STROKE | 1.4 mm | |
| FORCES | 0.2 N initial | 0.36 N at 1/2 stroke |
| MECHANICAL LIFE | 40'000 cycles | |
| OPERATING CURRENT | Max. 2 A | |
| CONTACT RESISTANCE | 20 mΩ (static measurement, halfway position) | |

ORDERING INFORMATION ROHS COMPLIANT PARTS

| PLATING CODE | PIN | PISTON |
|--------------|-----|------------------|
| 28 | Tin | 0.3 µm min. gold |

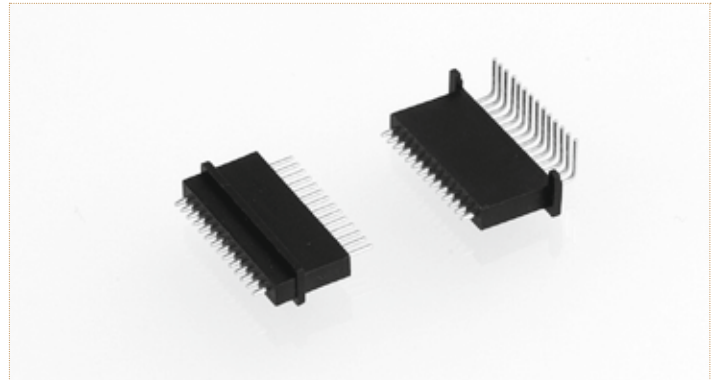

See page 178 for plating specs.

Surface mount miniature SLC connectors available on request.

Please consult.

8PD-28-0014-01-812

Straight SLC connector, solder tail, single row

Standard number of contacts: 14

Please consult for other pin number or partially equipped connectors

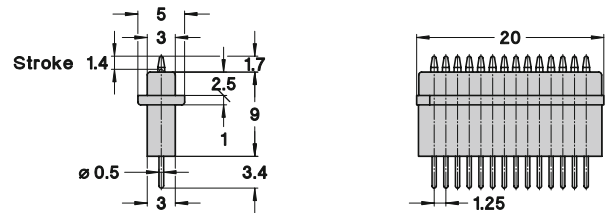

8PC-28-0014-01-828

Right angle SLC connector, solder tail, single row

Standard number of contacts: 14

Please consult for other pin number or partially equipped connectors

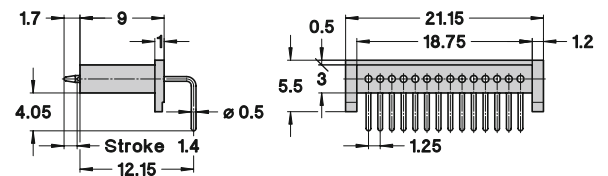



preci-dip

WWW.PRECIDIP.COM TEL +41 32 421 04 00 SALES@PRECIDIP.COM

SPRING-LOADED CONNECTORS

2 mm GRID / SINGLE ROW / DOUBLE ROW / SURFACE MOUNT

Basic modular connectors with spring-loaded contacts (SLC), surface mount. Contacts with hollow piston design for low profile.

TECHNICAL SPECIFICATIONS (FOR GENERAL SPECS, SEE PAGE 31)

| | | |
|--------------------|---|----------------------|
| INSULATOR | Black glass filled polyester PCT-GF30-FR | |
| FLAMMABILITY | UL 94V-0 | |
| PISTON AND BARREL | Brass CuZn36Pb3 (C36000) | |
| SPRING | Stainless steel X12 CrNi177, DIN 17224 | |
| MAX. STROKE | 1.4 mm | |
| FORCES | 0.3 N initial | 0.85 N at 1/2 stroke |
| MECHANICAL LIFE | 50'000 cycles | |
| OPERATING CURRENT | Max. 3.5 A | |
| CONTACT RESISTANCE | 10 mΩ (static measurement, halfway position) | |
| COPLANARITY | Max. 0.1 mm (measured on 25 mm long connectors) | |
| SMD TERMINATIONS | | |

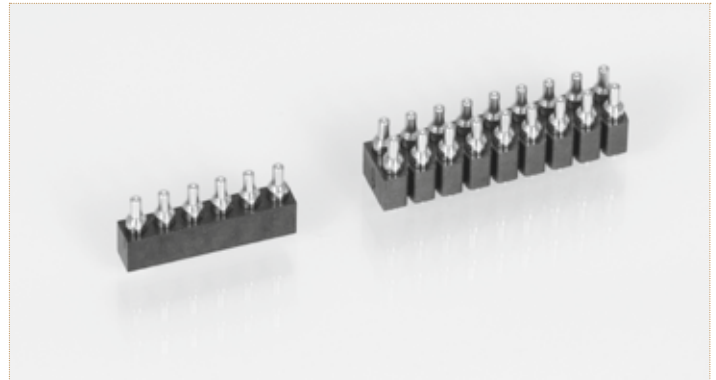

SPRING-LOADED CONNECTORS

ORDERING INFORMATION ROHS COMPLIANT PARTS

| | | |
|--------------|--------------|-------------|
| PLATING CODE | BARREL | PISTON |
| S1 | 0.25 μm gold | 0.5 μm gold |

See page 178 for plating specs.

NNN number of poles. Replace **NNN** with the requested number of poles, e.g. 821-SS-**NNN**-30-012101 for a single row version with 16 pins becomes 821-SS-**016**-30-012101.

821-SS-**NNN**-30-**XXX**101

Surface mount SLC connector, low profile, single row

AVAILABILITY FROM 2 to 10 contacts
(standard number of contacts: 10)



T & R Packaging

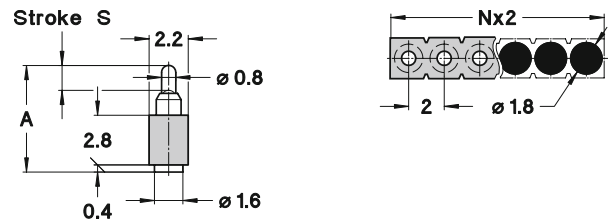

823-SS-**NNN**-30-**XXX**101

Surface mount SLC connector, low profile, double row

AVAILABILITY FROM 4 to 20 contacts
(standard number of contacts: 20)



T & R Packaging

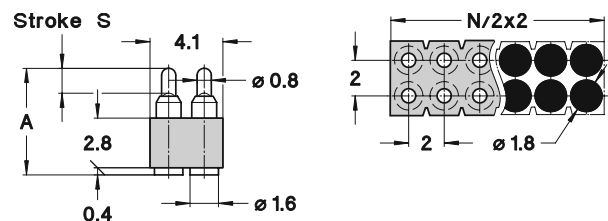

AVAILABLE CONNECTOR HEIGHTS

| INITIAL HEIGHT A (mm) | STROKE S (mm) | XXX CODE |
|-----------------------|---------------|----------|
| 5 | 1.4 | 012 |
| 5.5 | 1.4 | 013 |
| 6 | 1.4 | 014 |
| 6.5 | 1.4 | 015 |



preci-dip

WWW.PRECIDIP.COM TEL +41 32 421 04 00 SALES@PRECIDIP.COM

SPRING-LOADED CONNECTORS

2.54 mm GRID / SINGLE ROW / DOUBLE ROW / SOLDER TAIL

Low resistance modular connectors with spring-loaded contacts (SLC), solder tail. Contacts with improved, shaped piston design.

TECHNICAL SPECIFICATIONS (FOR GENERAL SPECS, SEE PAGE 31)

| | | |
|---------------------------|--|----------------------|
| INSULATOR | Black glass filled polyester PCT-GF30-FR | |
| FLAMMABILITY | UL 94V-0 | |
| PISTON AND BARREL | Brass CuZn36Pb3 (C36000) | |
| SPRING | Music wire DIN 17223, gold plated | |
| MAX. STROKE | 1.4 mm | |
| FORCES | 0.25 N initial | 0.85 N at 1/2 stroke |
| MECHANICAL LIFE | 50'000 cycles | |
| OPERATING CURRENT | Max. 3.5 A | |
| CONTACT RESISTANCE | 10 mΩ (static measurement, halfway position) | |

ORDERING INFORMATION ROHS COMPLIANT PARTS

| PLATING CODE | BARREL | PISTON |
|--------------|--------------|-------------|
| S1 | 0.25 μm gold | 0.5 μm gold |
| SS | 0.5 μm gold | 0.5 μm gold |

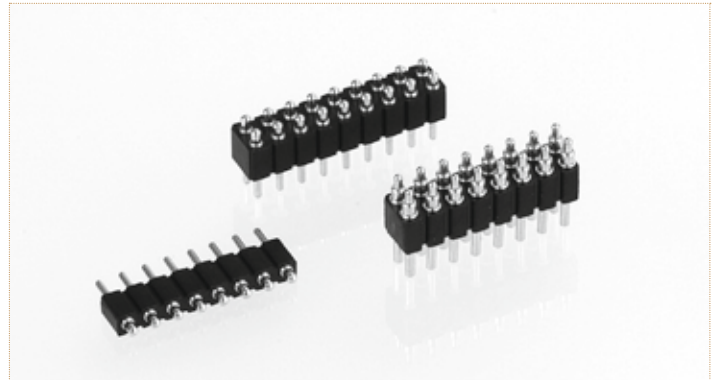

See page 178 for plating specs.

NNN number of poles: Replace **NNN** with the requested number of poles, e.g. 813-S1-**NNN**-10-014101 for a double row version with 16 pins becomes 813-S1-**016**-10-01410110-001101.

811-S1-**NNN**-10-**XXX**101

Straight SLC connector, low profile, solder tail, single row

AVAILABILITY FROM 2 to 64 contacts
(standard number of contacts: 64)

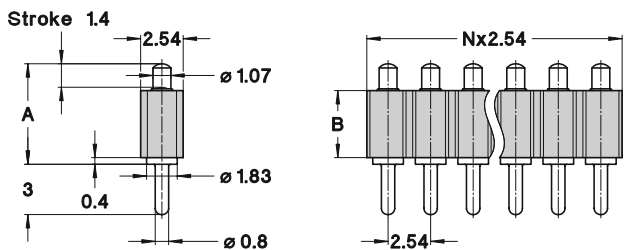

813-S1-**NNN**-10-**XXX**101

Straight SLC connector, low profile, solder tail, double row

AVAILABILITY FROM 4 to 72 contacts
(standard number of contacts: 72)

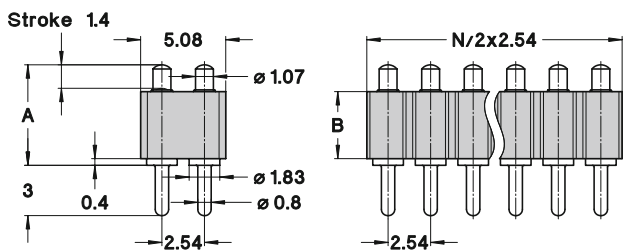

813-SS-**NNN**-10-474101

Straight SLC connector, solder tail, double row

AVAILABILITY FROM 4 to 64 contacts
(standard number of contacts: 64)

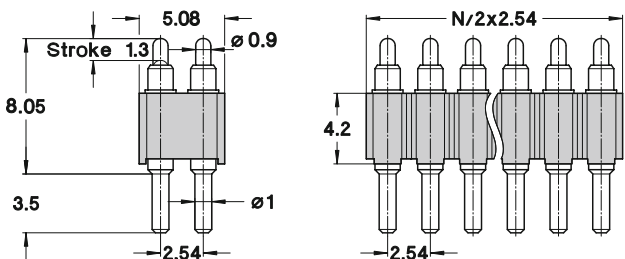

AVAILABLE CONNECTOR HEIGHTS

| INITIAL HEIGHT A (mm) | PLASTIC BODY HEIGHT B (mm) | XXX CODE |
|-----------------------|----------------------------|----------|
| 6 | 4 | 014 |
| 6.5 | 4 | 015 |
| 7 | 4 | 016 |
| 7.5 | 4 | 017 |



preci-dip

WWW.PRECIDIP.COM TEL +41 32 421 04 00 SALES@PRECIDIP.COM

SPRING-LOADED CONNECTORS

2.54 mm GRID / SINGLE ROW / DOUBLE ROW / SURFACE MOUNT

Basic modular connectors with spring-loaded contacts (SLC), surface mount. Contacts with hollow piston design for low profile.

TECHNICAL SPECIFICATIONS (FOR GENERAL SPECS, SEE PAGE 31)

| | | |
|------------------------------|---|---------------------|
| INSULATOR | Black glass filled polyester PCT-GF30-FR | |
| FLAMMABILITY | UL 94V-0 | |
| PISTON AND BARREL | Brass CuZn36Pb3 (C36000) | |
| SPRING | Stainless steel X12 CrNi177, DIN 17224 (Music wire DIN 17223, gold plated for 811...008101) | |
| MAX. STROKE | 1.4 mm (1 mm for 811-...-008101 and 1.5 mm for 811/813-...-001101) | |
| FORCES | 0.25 N initial | 0.6 N at 1/2 stroke |
| MECHANICAL LIFE | 100'000 cycles | |
| OPERATING CURRENT | Max. 3.5 A | |
| CONTACT RESISTANCE | 15 mΩ (static measurement, halfway position) | |
| COPLANARITY SMD TERMINATIONS | Max. 0.1 mm (measured on 25 mm long connectors) | |

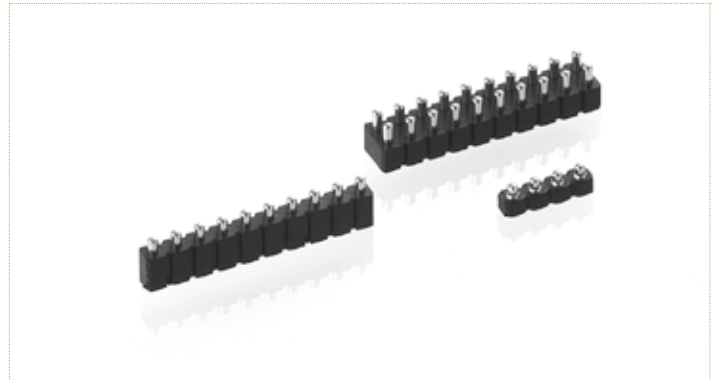

ORDERING INFORMATION ROHS COMPLIANT PARTS

| | | |
|--------------|-------------|-------------|
| PLATING CODE | BARREL | PISTON |
| SS | 0.5 μm gold | 0.5 μm gold |

See page 178 for plating specs.

NNN number of poles. Replace **NNN** with the requested number of poles, e.g. 811-SS-**NNN**-30-002101 for a single row version with 16 pins becomes 811-SS-**016**-30-002101.

811-SS-**NNN**-30-008101

Surface mount SLC connector, very low profile, single row

AVAILABILITY FROM 2 to 10 contacts
(standard number of contacts: 10)



T & R Packaging

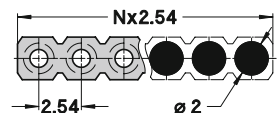
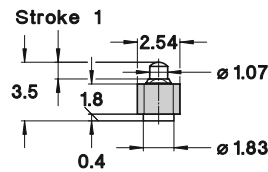

811-SS-**NNN**-30-**XXX**101

Surface mount SLC connector, low profile, single row

AVAILABILITY FROM 2 to 10 contacts
(standard number of contacts: 10)



T & R Packaging

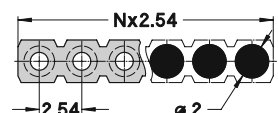
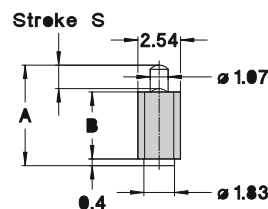

813-SS-**NNN**-30-**XXX**101

Surface mount SLC connector, low profile, double row

AVAILABILITY FROM 4 to 20 contacts
(standard number of contacts: 20)



T & R Packaging

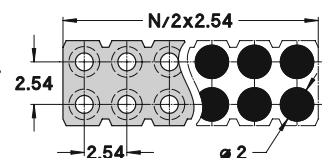
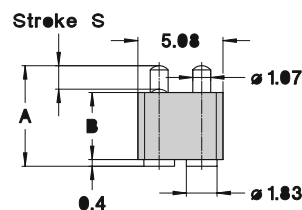

AVAILABLE CONNECTOR HEIGHTS

| INITIAL HEIGHT A (mm) | STROKE S (mm) | PLASTIC BODY HEIGHT B (mm) | XXX CODE |
|-----------------------|---------------|----------------------------|----------|
| 4.5 | 1.15 | 2.95 | 001 |
| 5 | 1.4 | 2.95 | 002 |
| 5.5 | 1.4 | 2.95 | 003 |
| 6 | 1.4 | 4 | 004 |
| 6.5 | 1.4 | 4 | 005 |
| 7 | 1.4 | 4 | 006 |
| 7.5 | 1.4 | 4 | 007 |



preci-dip

WWW.PRECIDIP.COM TEL +41 32 421 04 00 SALES@PRECIDIP.COM

SPRING-LOADED CONNECTORS

2.54 mm GRID / SINGLE ROW / DOUBLE ROW / SURFACE MOUNT

Low resistance modular connectors with spring-loaded contacts (SLC), surface mount. Contacts with improved shaped piston design.

TECHNICAL SPECIFICATIONS (FOR GENERAL SPECS, SEE PAGE 31)

| | | |
|---------------------------|---|----------------------|
| INSULATOR | Black glass filled polyester PCT-GF30-FR | |
| FLAMMABILITY | UL 94V-0 | |
| PISTON AND BARREL | Brass CuZn36Pb3 (C36000) | |
| SPRING | Music wire DIN 17223, gold plated | |
| MAX. STROKE | 1.4 mm | |
| FORCES | 0.25 N initial | 0.85 N at 1/2 stroke |
| MECHANICAL LIFE | 50'000 cycles | |
| OPERATING CURRENT | Max. 3.5 A | |
| CONTACT RESISTANCE | 10 mΩ (static measurement, halfway position) | |
| COPLANARITY | Max. 0.1 mm (measured on 25 mm long connectors) | |
| SMD TERMINATIONS | | |

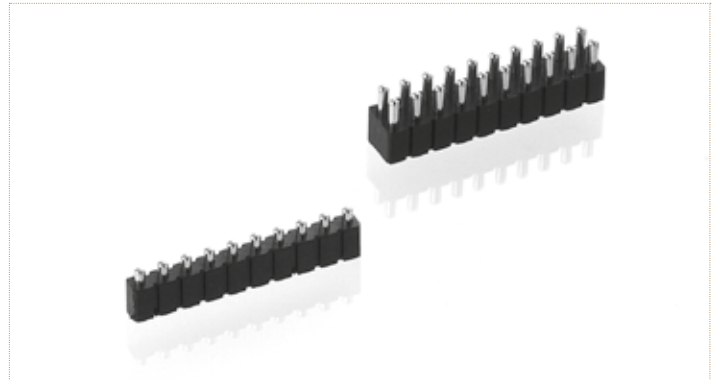

ORDERING INFORMATION ROHS COMPLIANT PARTS

| | | |
|---------------------|---------------|---------------|
| PLATING CODE | BARREL | PISTON |
| S1 | 0.25 μm gold | 0.5 μm gold |

See page 178 for plating specs.

NNN number of poles. Replace **NNN** with the requested number of poles, e.g. 813-S1-**NNN**-30-014101 for a double row version with 16 pins becomes 813-S1-**016**-30-014101.

811-S1-**NNN**-30-**XXX**101

Surface mount SLC connector, low profile, single row

AVAILABILITY FROM 2 to 10 contacts
(standard number of contacts: 10)



T & R Packaging

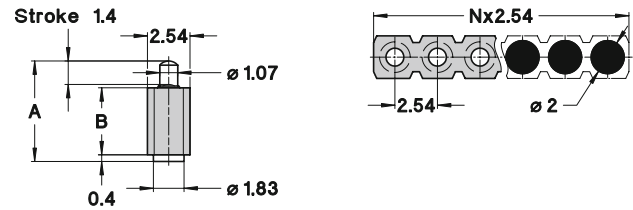

813-S1-**NNN**-30-**XXX**101

Surface mount SLC connector, low profile, double row

AVAILABILITY FROM 4 to 20 contacts
(standard number of contacts: 20)



T & R Packaging

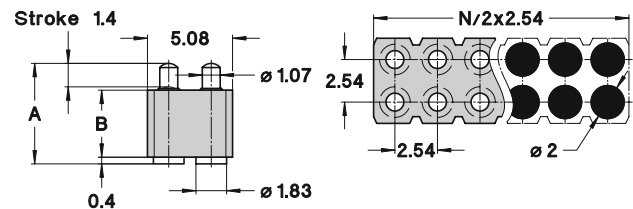

AVAILABLE CONNECTOR HEIGHTS

| INITIAL HEIGHT A (mm) | PLASTIC BODY HEIGHT B (mm) | XXX CODE |
|-----------------------|----------------------------|----------|
| 6 | 4 | 014 |
| 6.5 | 4 | 015 |
| 7 | 4 | 016 |
| 7.5 | 4 | 017 |



preci-dip

WWW.PRECIDIP.COM TEL +41 32 421 04 00 SALES@PRECIDIP.COM

SPRING-LOADED CONNECTORS

2.54 mm GRID / SINGLE ROW / DOUBLE ROW / SURFACE MOUNT

Basic modular connectors with spring-loaded contacts (SLC), surface mount with positioning pins. Contacts with hollow piston design for low profile.

TECHNICAL SPECIFICATIONS (FOR GENERAL SPECS, SEE PAGE 31)

| | |
|---------------------------|---|
| INSULATOR | Black glass filled polyester PCT-GF30-FR |
| FLAMMABILITY | UL 94V-0 |
| PISTON AND BARREL | Brass CuZn36Pb3 (C36000) |
| SPRING | Stainless steel X12 CrNi177, DIN 17224 |
| MAX. STROKE | 1.4 mm (1.15 mm for 811/813-...-021101) |
| FORCES | 0.25 N initial 0.6 N at 1/2 stroke |
| MECHANICAL LIFE | 100'000 cycles |
| OPERATING CURRENT | Max. 3.5 A |
| CONTACT RESISTANCE | 15 mΩ (static measurement, halfway position) |
| COPLANARITY | |
| SMD TERMINATIONS | Max. 0.1 mm (measured on 25 mm long connectors) |



ORDERING INFORMATION ROHS COMPLIANT PARTS

| | | |
|---------------------|---------------|---------------|
| PLATING CODE | BARREL | PISTON |
| SS | 0.5 μm gold | 0.5 μm gold |

See page 178 for plating specs.

NNN number of poles. Replace **NNN** with the requested number of poles, e.g. 813-SS-**NNN**-30-021101 for a double row version with 16 pins becomes 813-SS-**016**-30-021101.

811-SS-**NNN**-30-**XXX**101

Surface mount SLC connector, low profile, single row, with 2 positioning pins

AVAILABILITY FROM 2 to 10 contacts
(standard number of contacts: 10)

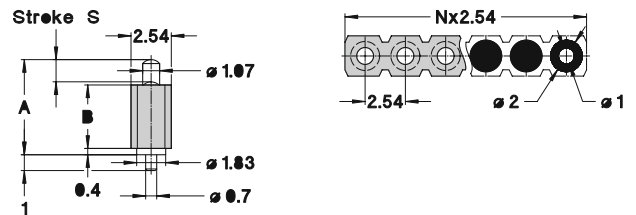

813-SS-**NNN**-30-**XXX**101

Surface mount SLC connector, double row, with 4 positioning pins

AVAILABILITY FROM 4 to 20 contacts
(standard number of contacts: 20)

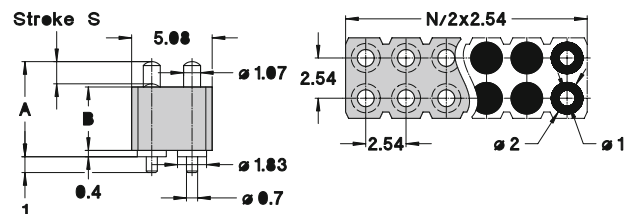

AVAILABLE CONNECTOR HEIGHTS

| INITIAL HEIGHT A (mm) | STROKE S (mm) | PLASTIC BODY HEIGHT B (mm) | XXX CODE |
|-----------------------|---------------|----------------------------|----------|
| 4.5 | 1.15 | 2.95 | 021 |
| 5 | 1.4 | 2.95 | 022 |
| 5.5 | 1.4 | 2.95 | 023 |
| 6 | 1.4 | 4 | 024 |
| 6.5 | 1.4 | 4 | 025 |
| 7 | 1.4 | 4 | 026 |
| 7.5 | 1.4 | 4 | 027 |



preci-dip

WWW.PRECIDIP.COM TEL +41 32 421 04 00 SALES@PRECIDIP.COM

SPRING-LOADED CONNECTORS

2.54 mm GRID / SINGLE ROW / DOUBLE ROW / SURFACE MOUNT

Connectors with spring-loaded contacts (SLC), surface mount.

TECHNICAL SPECIFICATIONS (FOR GENERAL SPECS, SEE PAGE 31)

| | | | |
|---------------------------|---|--|--|
| INSULATOR | Black glass filled polyester PCT-GF30-FR | | |
| FLAMMABILITY | UL 94V-0 | | |
| PISTON AND BARREL | Brass CuZn36Pb3 (C36000) | | |
| SPRING | 8PM...131 | 8PM...219 | 8PM...260 |
| | Music wire DIN 17723, gold plated | Stainless steel X12 CrNi177, DIN 17224 | Stainless steel X12 CrNi177, DIN 17224 |
| MAX. STROKE | 1.5 mm | 1 mm | 1.5 mm |
| FORCES | 0.2 N initial 0.9 N at 1/2 stroke | 0.25 N initial 0.95 N at 1/2 stroke | 0.25 N initial 0.6 N at 1/2 stroke |
| MECHANICAL LIFE | 50'000 cycles | 50'000 cycles | 100'000 cycles |
| OPERATING CURRENT | Max. 3 A | Max. 3 A | Max. 3 A |
| CONTACT RESISTANCE | 10 mΩ (static measurement, halfway position) | 10 mΩ | 15 mΩ |
| COPLANARITY | Max 0.1 mm (measured on 25 mm long connectors) | | |

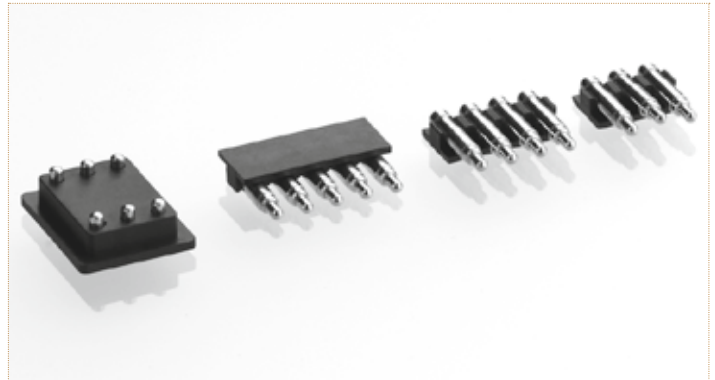

Other plating on request (see page 178 for plating specs).

NN number of poles. Replace NN with the requested number of poles, e.g. 8PM-11-00NN-02-131 with 5 pins becomes 8PM-11-0005-02-131.

ORDERING INFORMATION ROHS COMPLIANT PARTS

| | | |
|---------------------|---------------|---------------|
| PLATING CODE | BARREL | PISTON |
| 11 | 0.25 µm gold | 0.25 µm gold |
| SS | 0.5 µm gold | 0.5 µm gold |

8PM-11-00NN-02-260

Parallel surface mount SLC connector for pick & place automatic assembly

AVAILABILITY FROM 2 to 10 contacts
(standard number of contacts: 10)



T & R Packaging

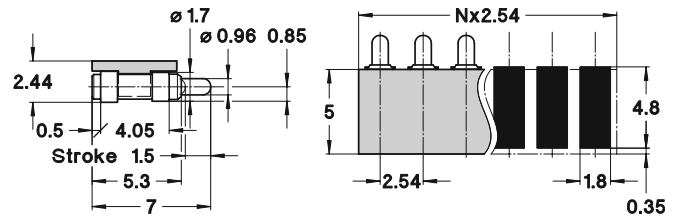

8PM-11-00NN-02-131

Parallel surface mount SLC connector for pick & place automatic assembly

AVAILABILITY FROM 2 to 10 contacts
(standard number of contacts: 10)



T & R Packaging

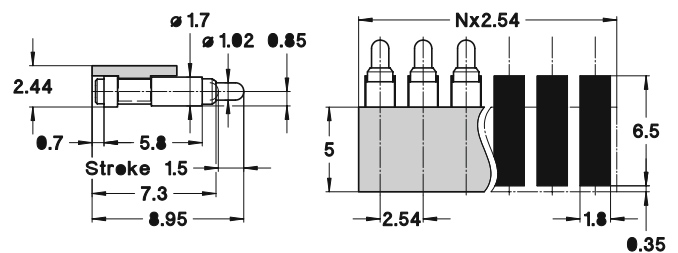

8PM-SS-0006-02-219

SLC connector for chipcards with contacting pads acc. to ISO 7816

Standard number of contacts: 6



T & R Packaging

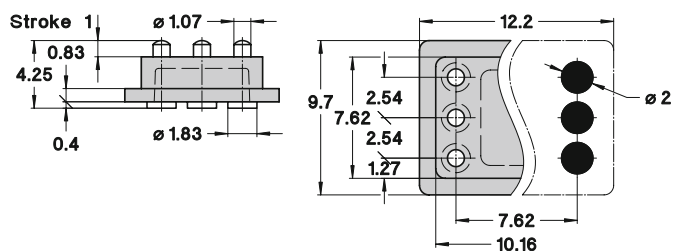



preci-dip

WWW.PRECIDIP.COM TEL +41 32 421 04 00 SALES@PRECIDIP.COM

PAD CONNECTORS

SINGLE ROW / DOUBLE ROW / SURFACE MOUNT

Pad connectors with fixed contacts, counterparts for spring-loaded connectors.

TECHNICAL SPECIFICATIONS (FOR GENERAL SPECS, SEE PAGE 31)

| | |
|---------------------|---|
| INSULATOR | Black glass filled polyester PCT-GF30-FR |
| FLAMMABILITY | UL 94V-0 |
| CONTACT | Brass CuZn36Pb3 (C36000) |
| CONTACTING AREA Ø | 1.5 mm |
| OPERATING CURRENT | Max. 3.5 A |
| DIELECTRIC STRENGTH | Min. 1'000 V _{RMS} |
| COPLANARITY | |
| SMD TERMINATIONS | Max. 0.1 mm (measured on 25 mm long connectors) |

ORDERING INFORMATION ROHS COMPLIANT PARTS

| PLATING CODE | TERMINATION | CONTACTING AREA |
|--------------|--------------|-----------------|
| 10, 11 | 0.25 µm gold | 0.25 µm gold |



SPRING-LOADED CONNECTORS

See page 178 for plating specs.

NNN / NN number of poles. Replace **NNN** or **NN** with the requested number of poles, e.g. 802-10-**NNN**-30-507101 for a double row version with 20 pins becomes 802-10-**020**-30-507101.

800-10-**NNN**-30-507101

SMD pad connector, single row, perpendicular mount

AVAILABILITY FROM 2 to 10 contacts
(standard number of contacts: 10)



T & R Packaging

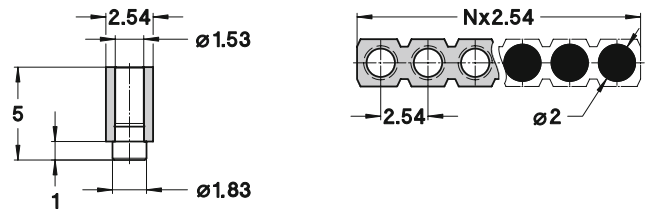

802-10-**NNN**-30-507101

SMD pad connector, double row, perpendicular mount

AVAILABILITY FROM 4 to 20 contacts
(standard number of contacts: 20)



T & R Packaging

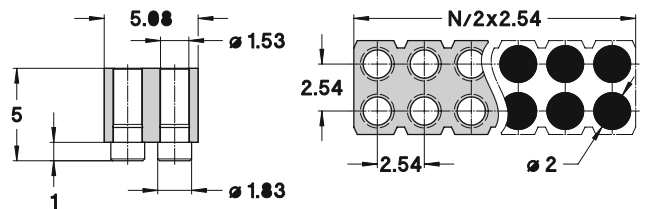

8MM-11-00**NN**-02-131

SMD pad connector, single row, parallel mount

AVAILABILITY FROM 2 to 10 contacts
(standard number of contacts: 10)



T & R Packaging

