

This document is the property of Amphenol Corporation and is delivered on the express condition that it is not to be disclosed, reproduced or used, in whole or in part, for manufacture or sale by anyone other than Amphenol Corporation without its prior consent, and that no right is granted to disclose or to use any information in this document.

The marking on this product doesn't contain environmental hazardous materials per Material Specification SS-00259 For Sony GP compliant or per directive 2002/95/EC For RoHS compliant.

CUSTOMER DRAWING

**PRELIMINARY RELEASE
SUBJECT TO CHANGE**

REVISIONS				
SYM	ECN No.	DESCRIPTION	DATE	APPROVED
AX1	/	RELEASE DRAWING	02/20/2019	Lawrence Chan
AX2	/	UPDATE DRAWING: Update Panel Cutout Proposal Diagram	02/22/2019	Lawrence Chan

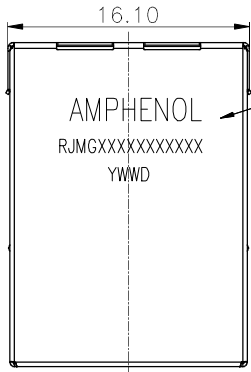

P/N & DATE CODE
Y=YEAR
WW=WEEK
D=DAY

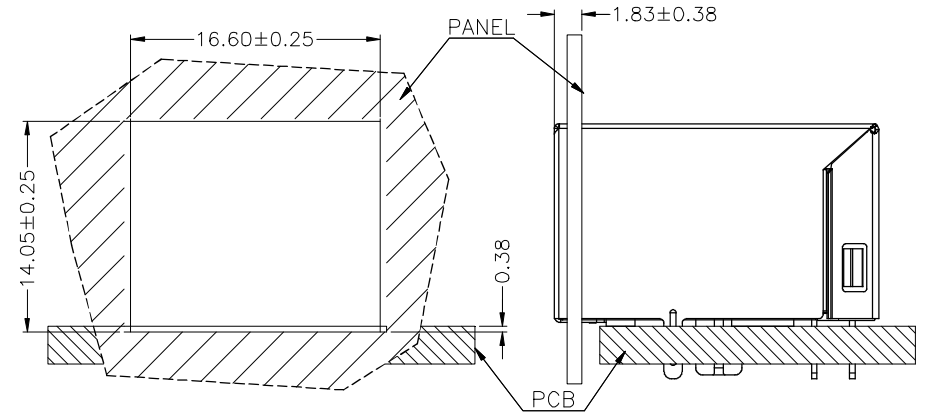
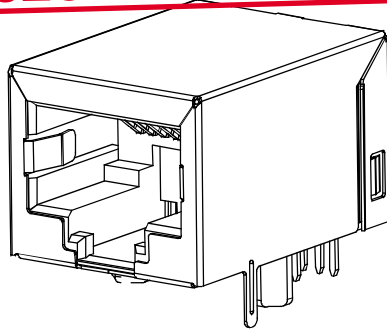

SUGGESTED PANEL CUTOUT

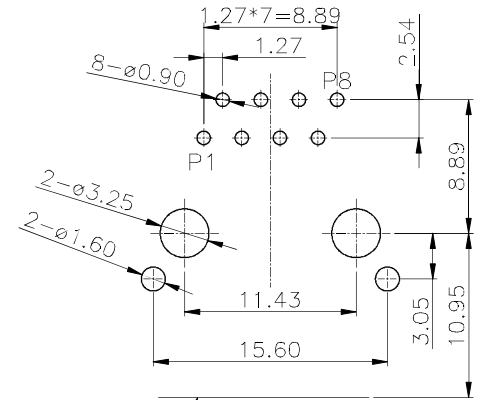
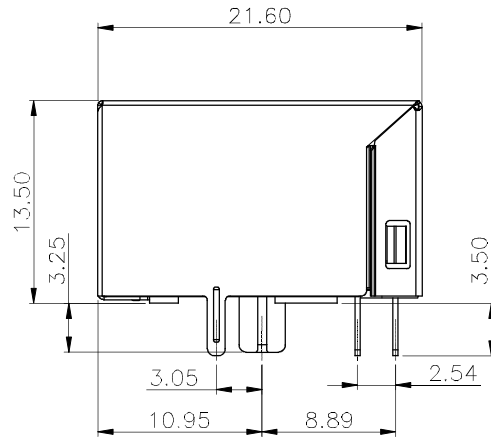
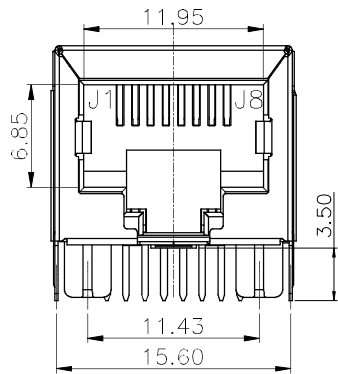

Recommended PCB Layout
(Tol: ±0.05, T=1.60±0.15mm)

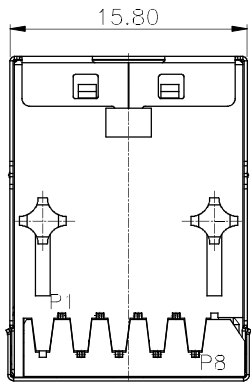

TOLERANCE	APPROVALS	DATE	TITLE		PART No.	
X. ±0.30	DRAWN Arvin Ye	02/22/2019	RJ45 1X1 10/100 TYPE WITH FILTER		Amphenol®	
X.XX ±0.25					Amphenol Corporation	
X.XXX ±0.15	CHECKED Vivian Wen	02/22/2019			Amphenol Taiwan Corporation	
ANGULAR ±1°	APPROVED Lawrence Chan	02/22/2019			RJMG1S8008101XR	
UNLESS OTHERWISE SPECIFIED	DWG TYPE CUST DWG	PROJECT CODE -			UNIT mm	SIZE A3
					SCALE NA	SHEET 1 OF 2
					DWG No.	REV.
					RJMG1S8008101XR	AX2

This document is the property of Amphenol Corporation and is delivered on the express condition that it is not to be disclosed, reproduced or used, in whole or in part, for manufacture or sale by anyone other than Amphenol Corporation without its prior consent, and that no right is granted to disclose or to use any information in this document.

The marking on this product doesn't contain environmental hazardous materials per Material Specification SS-00259 For Sony GP compliant per directive 2002/95/EC For RoHS compliant.

CUSTOMER DRAWING

REVISIONS				
SYM	ECN No.	DESCRIPTION	DATE	APPROVED
AX1	/	RELEASE DRAWING	02/20/2019	Lawrence Chan
AX2	/	UPDATE DRAWING:Update Panel Cutout Proposal Diagram	02/22/2019	Lawrence Chan

**PRELIMINARY RELEASE
SUBJECT TO CHANGE**

SCHEMATIC DRAWING

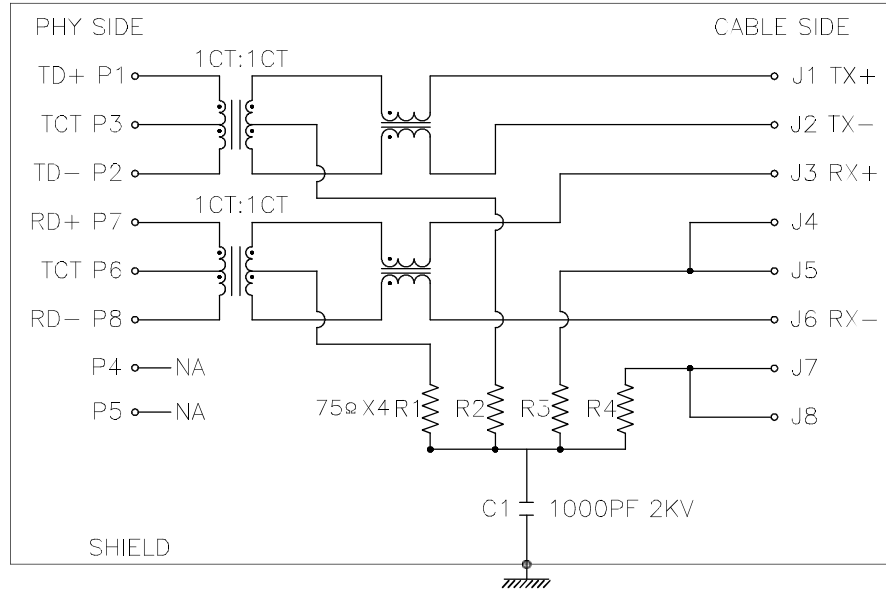

MATERIALS:

1.Terminal Parts:

- 1.1.RJ Terminal :Phosphor Bronze,C5191,Thickness=0.30mm
Finish:gold plating(SEE P/N) on contact area,100u" min. tin on solder tail area,underplating 30u" MIN. Nickel over all.
- 1.2.RJ input Terminal :Brass,Thickness=0.35mm
Finish:100u" min. tin over 30u" MIN. Nickel.
- 1.3.Module Terminal :Brass,Thickness=0.25mm
Finish:100u" min. tin over 30u" MIN. Nickel.

2.Plastic Parts:

- 2.1.Housing : HIGH TEMPERATURE PLASTIC
Flame Class:UL94 V-0
- 2.2.Coil Case : HIGH TEMPERATURE PLASTIC
Flame Class:UL94 V-0

3.Shell Parts:

- 3.1.Shield : Stainless steel,SUS304,Thickness=0.20mm,
30u" MIN. Ni PLATED OVERALL

OTHERS:

- 1.Operating Temperature : -40°C TO +85°C
- 2.Storage Temperature : -40°C TO +85°C
- 3.JACK CAVITY CONFORMS TO FCC RULES AND REGULATIONS
PART 68 , SUBPART F
- 4. TEMPERATURE CONDITION OF IR
REFLOW:260±3°C, 10S MAX.



ELECTRICAL SPECIFICATION(@25° C) CONNECTOR PERFORMANCE

PARAMETER	LIMITS (MAX. OR MIN.)	FREQUENCY RANGE/ TEST CONDITIONS
INSERTION LOSS (RX/TX)	-1.0dB MAX.	1-100 MHz
RETURN LOSS (RX/TX)	-16dB MIN. -12dB MIN. -10dB MIN.	1-30 MHz 30-60 MHz 60-80 MHz
CROSSTALK ISOLATION (RX/TX)	-30dB MIN.	1-100 MHz
HIPOT (ISOLATION)	2250V DC	60 Sec.
OCL	350uH MIN.	100KHz 100mV 8mA
TURN RATIO	1:1±5%	

PART NO. RJMG1S8 0 0 8101 X R

Plating and Packaging:

- B: gold 6u", tray
- C: gold flash, tray
- D: gold 15u", tray
- E: gold 30u", tray
- F: gold 50u", tray

TOLERANCE	APPROVALS	DATE	TITLE		PART No.	
X. X.X ±0.30 X.XX ±0.25 X.XXX ±0.15 ANGULAR ±1° UNLESS OTHERWISE SPECIFIED	DRAWN	Arvin Ye	RJ45 1X1 10/100		Amphenol®	
	CHECKED	Vivian Wen	TYPE WITH FILTER		Amphenol Corporation Amphenol Taiwan Corporation	
	APPROVED	Lawrence Chan	02/22/2019	UNIT mm	SIZE A3	PART No. RJMG1S8008101XR
	DWG TYPE	CUST DWG	PROJECT CODE	SCALE NA	SHEET 2 OF 2	DWG No. RJMG1S8008101XR REV. AX2

