

PLEASE CHECK WWW.MOLEX.COM FOR LATEST PART INFORMATION

Part Number: [0638139500](#)
Status: **Active**
Overview: [Application Tooling](#)
Description: Extractor Tool for MOX 0.635mm Receptacle Crimp Terminals

Documents:
[RoHS Certificate of Compliance \(PDF\)](#)

General

Product Family	Application Tooling
Series	207121
Comments	See Tooling Specification (PDF) Above
Function	Extraction
Geographic Area	Global
Level of Automation	Manual
More Detailed Tech Information	applicationtooling@molex.com
Overview	Application Tooling
Product Name	MOX
Taxonomy	Crimp Presses and Crimp Hand T
Tool Type	Extraction Hand Tool
UPC	884982407350
Warranty Disclaimer	CAUTION: Molex tooling crimp specifications are valid only when used with Molex terminals and tooling manufactured by Molex and sold by Molex or authorized distributors ("Molex Tooling"). When using tooling other than Molex Tooling with Molex specific connector systems listed in our ATS documents, the Molex tooling qualification does not apply and the responsibility for full qualification of the connector system is that of the customer. Molex accepts no liability for connector performance or tooling support where tooling other than Molex Tooling is used or where Molex Tooling is modified.

Material Info

Reference - Drawing Numbers
[Application Tooling Documents](#)

ATS-638139500-001

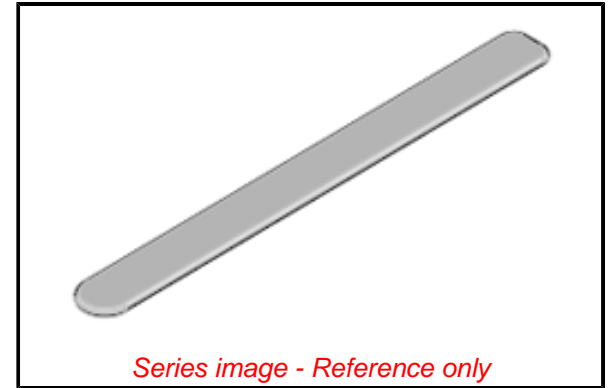

Series image - Reference only

EU ELV

Not Relevant

EU RoHS

Not Reviewed

REACH SVHC

Not Reviewed

Halogen-Free

Status

Not Relevant

For more information, please visit [Contact US](#)

China ROHS

Not Relevant

ELV

Not Relevant

RoHS Phthalates

Not Reviewed

Search Parts in this Series

[207121 Series](#)

Use With

[98495 35 Circuit Hybrid Female Receptacle Housing](#)

Application Tooling | **FAQ**

Description	Product #
FFC VER RCPT FEM CONN BLK 35Ckt	984951001
FFC VER RCPT FEM CONN BLU 35Ckt	984951006
FFC VER RCPT FEM CONN GRY 35Ckt	984951008
FFC VER RCPT FEM CONN BRN 35Ckt	984951009
RND WR VER RCPT CONN BLK 35Ckt	984952001
RND WR VER RCPT CONN BLU 35Ckt	984952006
RND WR VER RCPT CONN GRY 35Ckt	984952008

RND WR VER RCPT984952009
CONN BRN 35Ckt
NSCC Receptacle 988971109
Terminal Size 1.5,
Wire Size 0.22 up to
0.44mm²
NSCC Receptacle 988971119
Terminal Size 1.5,
Wire Size 0.49 up to
0.94mm²
NSCC Receptacle 988971129
Terminal Size 1.5,
Wire Size 0.95 up to
1.87mm²

This document was generated on 11/24/2022

PLEASE CHECK WWW.MOLEX.COM FOR LATEST PART INFORMATION